

'The units were made by hand'

Copy Hazel and Stephen Perry, and create your dream kitchen by designing it from scratch

FOR WHERE TO BUY ITEMS SHOWN, TURN THE PAGE

Bespoke design
Nearly 30 years after buying their farmhouse, Hazel and Stephen revamped its tired kitchen with traditional hand-crafted units and a seaside-inspired scheme

Love their STYLE?

THE PERRYS' SHAKER-STYLE UNITS ARE BY WOODCHESTER CABINET MAKERS £££. FOR SIMILAR, TRY WREN KITCHENS' SCULPTURED IN PERIWINKLE £ OR MAGNET'S SHAKER CREAM ££



Hazel and Stephen Perry bought their Cornish holiday home in 1986, after years of visiting the area. 'We live in Bristol, but this house (harlynfarmhouse.co.uk)

is in such a beautiful spot, we wanted to spend as much time as possible here while our children were small,' says Hazel. 'However, it took us nearly 30 years to update the kitchen.'

Originally the farmhouse dairy, the room had a galley layout, a low ceiling and an old electric oven. As the couple wanted the space to have a kitchen they could relax and eat in too, they decided to add an extension to the house before fitting it out with hand-made units. 'The colour scheme was inspired by the house's location,' says Hazel. 'From the windows, we can see rocks, sky, sea and sand, so we had the cabinetry painted blue. Even the granite of the worktops was picked for its resemblance to the rocks we get down here.'

So was the new kitchen worth waiting for? 'It has improved life here all round,' says Hazel.

TURN OVER TO FIND OUT HOW
Hazel and Stephen created their new kitchen

Take the 60-SECOND TOUR

THE PROPERTY

A 100-year-old, granite-built farmhouse in Padstow, Cornwall, bought in 1986.

WHO LIVES HERE

Hazel and Stephen Perry.

WHAT THEY DID

The couple built an extension to house an open-plan kitchen with living and dining areas, then installed a traditional hand-made kitchen and modern appliances.

THE LOOK

Classic Shaker style, with blue tones and limestone flooring that create a laid-back seaside theme.

LESSONS LEARNED

"It's vital to get on with the people you employ to do your build. I made a point of baking biscuits and buns for everyone on site each time we visited. They appreciated it and we think they worked even more enthusiastically as a result."

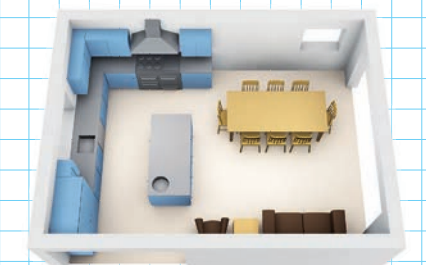

THE LAYOUT The base units are arranged in an L shape around an island. There are two sinks – one beneath the window and the other in the island. There's a dining and living area at the other end of the room

WHAT IT COST

Units.....	£15,676
Worktops and upstands.....	£2,964
Splashback.....	£1,146
Appliances.....	£5,195
Sinks.....	£624
Taps.....	£716
Flooring.....	£2,400
TOTAL.....	£28,721



Sociable space
The island, which has an additional sink, is ideal for preparing food while chatting to guests

FEATURE VICTORIA JENKINS
PHOTOGRAPHS WILLIAM GODDARD PLAN PERSONAHD

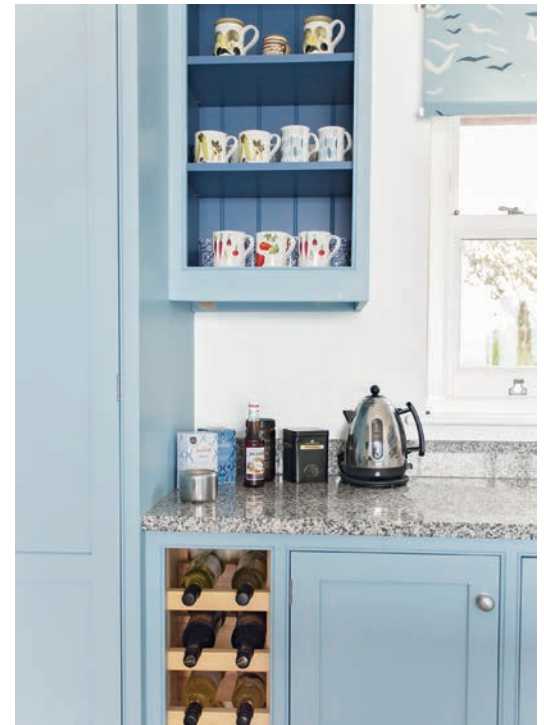

▲ True blue

Hazel had the interior of this wall unit painted dark blue to create a backdrop that contrasts with her white china



▲ Table talk

An extendable beech table from Ikea adds warmth to the scheme. Its simple lines complement the Shaker units



How we did it

“The extension for an open-plan kitchen with living and dining areas was a big part of a massive overhaul we gave the whole house. We asked architect Mark Gregory of MSG Arc Build to draw up the plans and our builder, Anthony Richards Construction, kept everything running smoothly. Woodchester Cabinet Makers designed, built and painted the units by hand. The building work and kitchen fitting took around nine months. Luckily, we could live in our house in Bristol at the time, so we didn't have to live with the upheaval going on around us.”

KITCHEN SOURCEBOOK WHERE TO BUY

Bespoke units, from £500 for a W600m unit, Woodchester Cabinet Makers. Granite **worktops** and **upstands**, from £400 per linear m, Trebarwith Stoneworks. Wave **splashback**, £1,622 per sq m, Steve Robinson. RUX110 **sink**, £243, Franke. Oberon U **tap** in Pewter, £358, Perrin & Rowe range, Just Perrin. For a similar **range cooker**, try the F1092DXEISS/C-EU, £3,855, Falcon range, Homecare Supplies. For a similar **extractor hood**, try the FHDSE1092SLN, £1,540, Falcon range, Appliances Direct. For a similar **dishwasher**, try the SN278101TG, £999, Siemens range, Ao.com. Dijon tumbled limestone **flooring**, from £42 per sq m, Mandarin Stone. Flight **blinds**, from £35 each, Scion range; Coastal Stripe **curtains** (on bifold doors), £25 per m; Pemberley **chairs**, £99 each; all John Lewis. Norden extendable **table**, £275, Ikea. For a similar **artwork**, try the St Ives canvas, £85, Iris Cleford range, Whistlefish

FOR DETAILS TURN TO
OUR SHOPPING DIRECTORY